



Rye Road, SE15 | £950,000

02087029666

peckham@pedderproperty.com

pedder
We live local



In General

- Loft extended family home
- Four double bedrooms
- Two bathrooms
- Through reception room
- Potential to extend kitchen STPP
- Over 1,560 SqFt.
- 0.8mi to Nunhead Station
- 0.9mi to both Brockley and Honor Oak Park Stations
- Moments away from Peckham Rye Park

In Detail

Set on one of Nunhead's most desirable residential streets, this attractive four-bedroom family home offers generous living space, excellent green space and superb transport connections in the heart of South East London.

Inside, the property boasts a bright and airy through reception room with ample space for both relaxing and dining. A spacious kitchen and conservatory lead to a well maintained, low maintenance garden, creating a wonderful setting for family life and entertaining, alike. The house is arranged over three floors, including four comfortable double bedrooms and two modern bathrooms, perfectly suited to growing families or those needing flexible work-from-home space.

Nunhead continues to be one of South East London's most popular neighbourhoods thanks to its strong sense of community, independent high streets, and its proximity to local amenities. Residents are moments from the fantastic selection of independent cafés, restaurants, and local shops, on both Lordship Lane and Evelina Road.

Rye Road itself is moments away from the beautiful Peckham Rye Park, offering an expanse of green space, perfect for weekend walks, outdoors activities, and family time.

The area is particularly well regarded for its choice of local schools, making it a popular destination for families looking to put down roots. Excellent transport links are also close at hand, with nearby stations, including Nunhead (Thameslink) and Brockley (Southern & Windrush), offering convenient connections into London Bridge, Victoria and the City.

A wonderful opportunity to acquire a beautiful family home in a vibrant and well-connected London neighbourhood.

EPC: C | Council tax band: D



Floorplan

Rye Road Peckham, SE15

Approximate Gross Internal Area
(Excluding Eaves)
146.1 sq m / 1562 sq ft



= Reduced headroom below 1.5 m / 5'0"

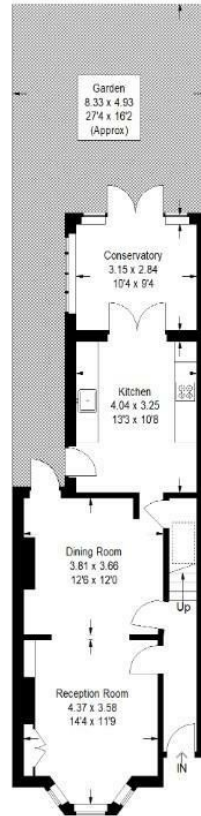

Ground Floor



Second Floor



First Floor

Copyright www.pedderproperty.com © 2026
These plans are for representation purposes only as defined by RICS - Code of Measuring Practice. Not drawn to Scale. Windows and door openings are approximate. Please check all dimensions, shapes and compass bearings before making any decisions reliant upon them.

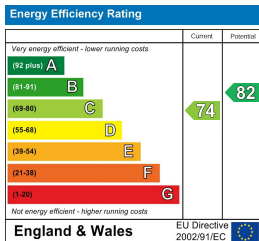

Pedder Property Ltd trading as Pedder for themselves and for the vendor/landlord of this property whose agents they are, give notice that (1) these particulars do not constitute any part of an offer or contract, (2) all statements contained within these particulars are made without responsibility on the part of Pedder or the vendor/landlord, (3) whilst made in good faith, none of the statements contained within these particulars are to be relied upon as a statement of representation or fact, (4) any intending purchaser/tenant must satisfy him/herself by inspection or otherwise as to the correctness of each of the statements contained within these particulars, (5) the vendor/landlord does not make or give either Pedder or any person in their employment any authority to make or give representation or warranty whatsoever in relation to this property.